



FLOORPLANS

Botanical

2 bedroom apartment
Type 18

Floors:
04 – 09

Apartment numbers:
B4.07, B5.06, B6.06, B7.06, B8.06 & B9.06

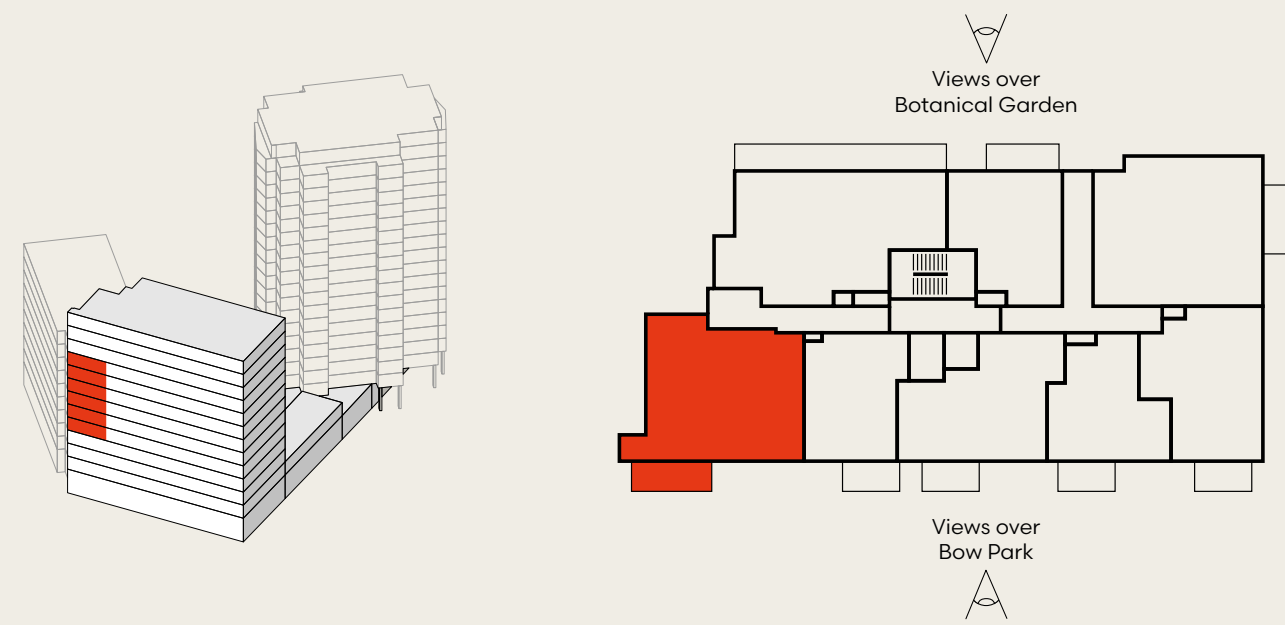

Total Internal Area	72.1 sq m	776 sq ft	◄► Measurement points
Total External Area	7.6 sq m	82 sq ft	W Wardrobe
Kitchen	3.01m x 2.75m	9' 10" x 9' 0"	OW Optional wardrobe
Living / Dining	5.28m x 3.41m	17' 4" x 11' 2"	CC Coat Cupboard
Bedroom 1	5.02m x 2.92m	16' 6" x 9' 7"	SC Storage Cupboard
Bedroom 2	3.82m x 2.55m	12' 7" x 8' 4"	UC Utility Cupboard
Balcony	4.67m x 1.72m	15' 4" x 5' 8"	W/D Washer/Dryer
			⊕ Optional Pendant Lights

Floorplans shown for Bow Green are for approximate measurements only. Exact layouts and sizes may vary. All measurements may vary within a tolerance of 5%. The dimensions are not intended to be used for carpet sizes, appliance sizes or items of furniture. Furniture layouts are indicative only.

