



FLOORPLANS

Botanical

2 bedroom apartment
Type 13A

Floors:
04 - 12

Apartment numbers:
B4.02, B6.02, B8.02, B10.02 & B12.02

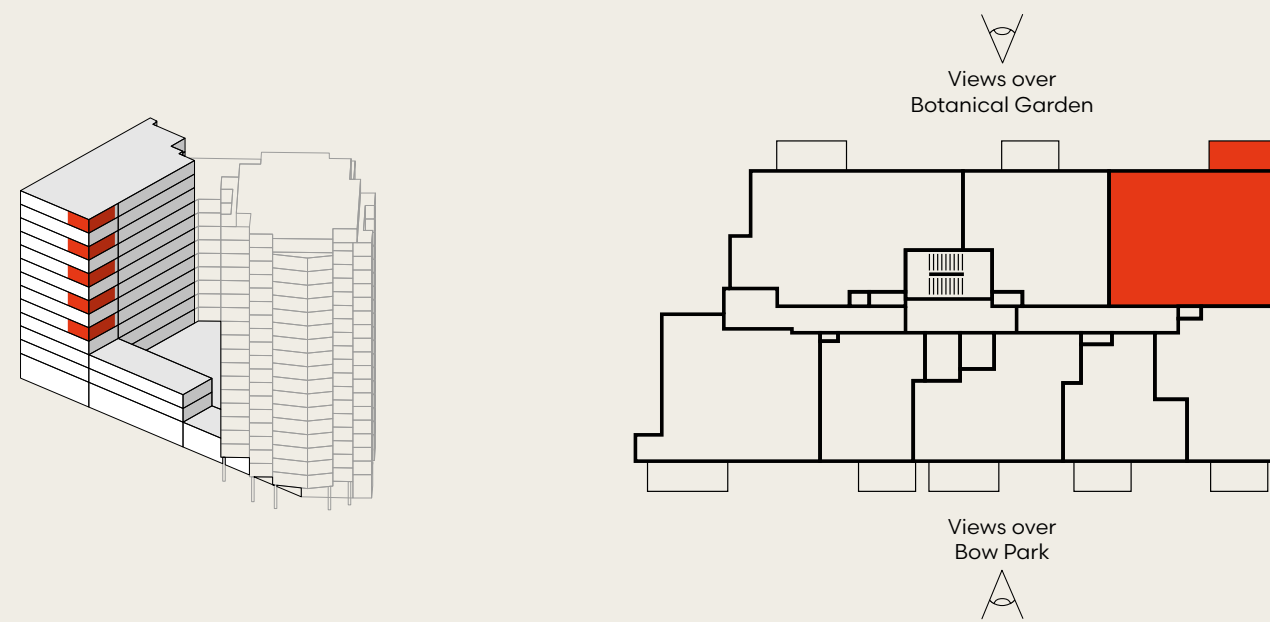

Total Internal Area	73.0 sq m	786 sq ft
Total External Area	6.5 sq m	70 sq ft
Kitchen	3.56m x 3.19m	11' 8" x 10' 6"
Living / Dining	3.04m x 5.33m	10' 0" x 17' 6"
Bedroom 1	5.08m x 2.83m	16' 8" x 9' 3"
Bedroom 2	3.56m x 3.23m	11' 9" x 10' 7"
Balcony	4.00m x 1.72m	13' 1" x 5' 8"

- ◄► Measurement points
- W Wardrobe
- OW Optional wardrobe
- CC Coat Cupboard
- SC Storage Cupboard
- UC Utility Cupboard
- W/D Washer/Dryer
- ⊕ Optional Pendant Lights

Floorplans shown for Bow Green are for approximate measurements only. Exact layouts and sizes may vary. All measurements may vary within a tolerance of 5%. The dimensions are not intended to be used for carpet sizes, appliance sizes or items of furniture. Furniture layouts are indicative only.

