



## FLOORPLANS

# Botanical

**2 bedroom apartment**  
Type 13

**Floors:**  
05 - 11

**Apartment numbers:**  
B5.02, B7.02, B9.02 & B11.02

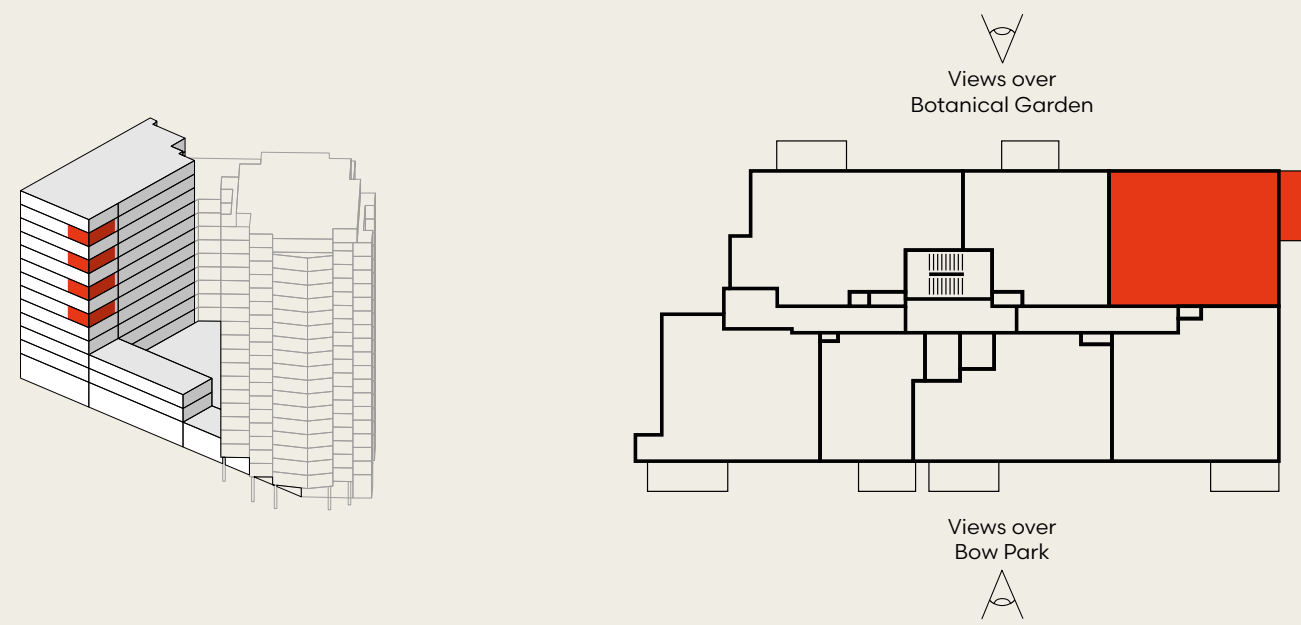

<b>Total Internal Area</b>	<b>73.0 sq m</b>	<b>786 sq ft</b>
<b>Total External Area</b>	<b>6.5 sq m</b>	<b>70 sq ft</b>
Kitchen	3.56m x 3.19m	11' 8" x 10' 6"
Living / Dining	3.04m x 5.33m	10' 0" x 17' 6"
Bedroom 1	5.08m x 2.83m	16' 8" x 9' 3"
Bedroom 2	3.56m x 3.23m	11' 8" x 10' 7"
Balcony	4.00m x 1.72m	13' 1" x 5' 8"

- ◄► Measurement points
- W Wardrobe
- OW Optional wardrobe
- CC Coat Cupboard
- SC Storage Cupboard
- UC Utility Cupboard
- W/D Washer/Dryer
- ⊕ Optional Pendant Lights

Floorplans shown for Bow Green are for approximate measurements only. Exact layouts and sizes may vary. All measurements may vary within a tolerance of 5%. The dimensions are not intended to be used for carpet sizes, appliance sizes or items of furniture. Furniture layouts are indicative only.

